

DOORS LEGEND

EXISTING DOOR TO REMAIN.

NEW SINGLE DOOR.

N.I.C. = NOT IN CONTRACT

PARTITION LEGEND

EXISTING PARTITION TO REMAIN.

NEW PARTITION.

- GENERAL CONSTRUCTION NOTES:**
- GENERAL CONTRACTOR TO REVIEW M/E DRAWINGS AND INCLUDE ALL RELATED ARCHITECTURAL WORK FOR REPAIRS, INCLUDING PATCHING AND PAINTING OF EXISTING SPACES BEYOND THE SCOPE SHOWN ON THE ARCHITECTURAL DRAWINGS, INCLUDING:
 - WALL PENETRATIONS
 - CORRIDOR WALLS AND CEILINGS MODIFICATIONS AND PENETRATIONS
 - FLOORS AND CONCRETE MODIFICATIONS AND PENETRATIONS
 - ANY RELATED WORK ON THE ADJACENT, ABOVE OR BELOW THE SPACES SHOWN IN THE SCOPE.
 - GENERAL CONTRACTOR TO REVIEW WORK RELATED TO FIRE RATING AND ENSURE FIRE RATING MATERIALS ARE SUBMITTED FOR CONSULTANT REVIEW AND APPROVAL. ALL PENETRATIONS ARE TO BE BROUGHT BACK TO THE SAME OR BETTER CONDITION.
 - GENERAL CONTRACTOR TO COORDINATE WORK IN ADJACENT SPACES WITH OWNER REPRESENTATIVE WHENEVER THERE IS WORK IN OTHER APARTMENT.

FINISHES NOTES:

- ALL NEW FLOORING TO BE LVT, KARNDIEN VAN GOGH, COLOUR: WEATHERED ASH VGM43T, GLUE DOWN
- ALL NEW AND EXISTING WALLS TO HAVE NEW STANDARD GREY 4" VINYL WALL BASE, INSTALLED ON BOTH SIDES WHERE APPLICABLE
- ALL NEW CEILINGS TO BE GWB

NOTE 1

CONTRACTOR TO PROVIDE PTAC UNIT SHOP DRAWINGS FOR M/E CONSULTANT REVIEW AND APPROVAL, AND TO CONFIRM THAT IT CAN FIT WITHIN THE LOWER PART OF THE WINDOW.



Sheet Title:
NEW FLOOR PLAN - APARTMENT UNIT 1

Project:
KINGSTON & FRONTENAC HOUSING CORPORATION
COMMON ROOM CONVERSION
205 RIDEAU STREET, BASEMENT FLOOR, KINGSTON, ON

ARCHICANA

Date: 12/07/2024	Scale: 1:50
Drawn By: SS	Revision: PERMIT / TENDER
Sheet Number: A-300	

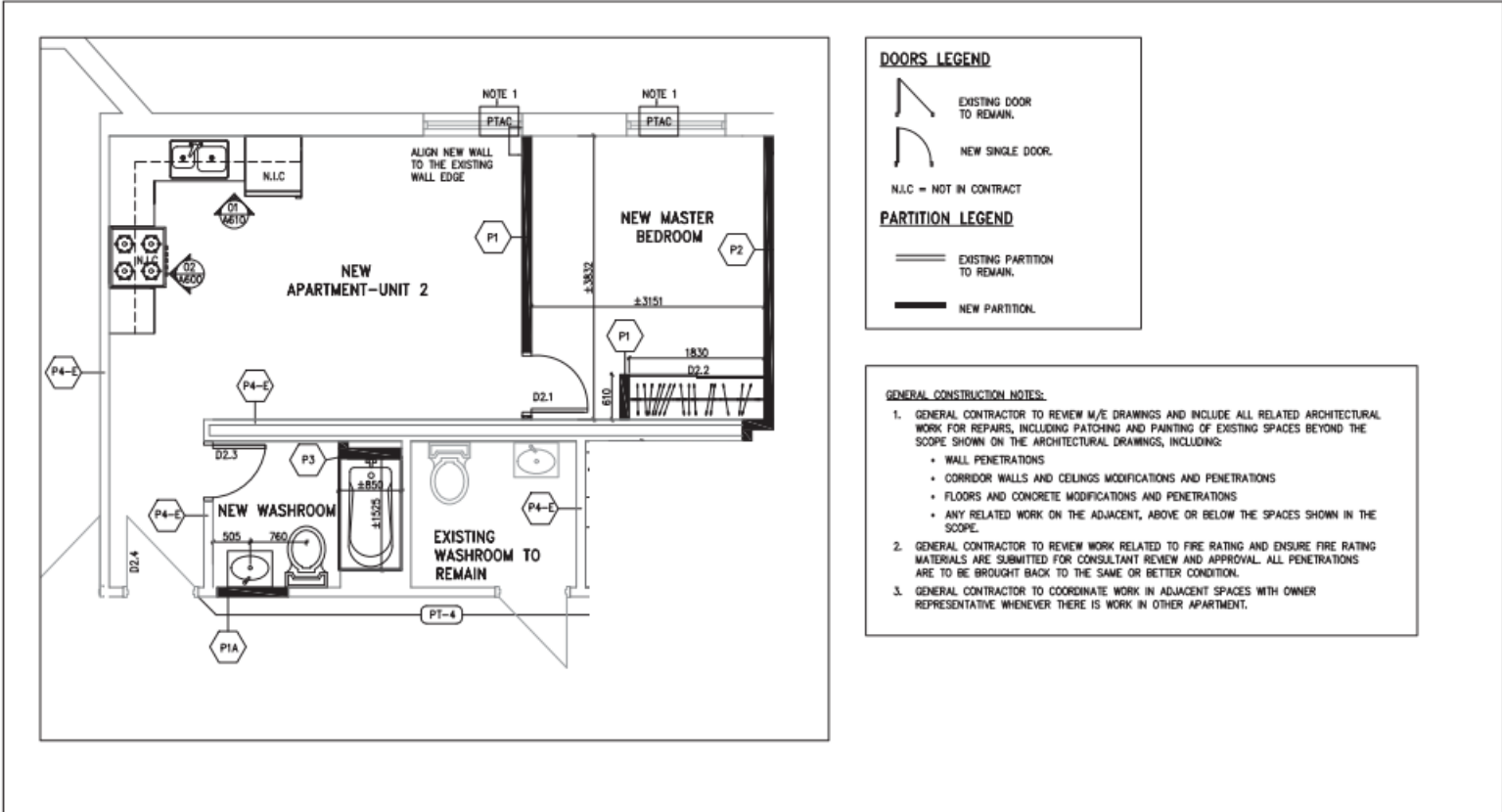

DOORS LEGEND

EXISTING DOOR TO REMAIN.

NEW SINGLE DOOR.

N.I.C. = NOT IN CONTRACT

PARTITION LEGEND

EXISTING PARTITION TO REMAIN.

NEW PARTITION.

- GENERAL CONSTRUCTION NOTES:**
- GENERAL CONTRACTOR TO REVIEW M/E DRAWINGS AND INCLUDE ALL RELATED ARCHITECTURAL WORK FOR REPAIRS, INCLUDING PATCHING AND PAINTING OF EXISTING SPACES BEYOND THE SCOPE SHOWN ON THE ARCHITECTURAL DRAWINGS, INCLUDING:
 - WALL PENETRATIONS
 - CORRIDOR WALLS AND CEILINGS MODIFICATIONS AND PENETRATIONS
 - FLOORS AND CONCRETE MODIFICATIONS AND PENETRATIONS
 - ANY RELATED WORK ON THE ADJACENT, ABOVE OR BELOW THE SPACES SHOWN IN THE SCOPE.
 - GENERAL CONTRACTOR TO REVIEW WORK RELATED TO FIRE RATING AND ENSURE FIRE RATING MATERIALS ARE SUBMITTED FOR CONSULTANT REVIEW AND APPROVAL. ALL PENETRATIONS ARE TO BE BROUGHT BACK TO THE SAME OR BETTER CONDITION.
 - GENERAL CONTRACTOR TO COORDINATE WORK IN ADJACENT SPACES WITH OWNER REPRESENTATIVE WHENEVER THERE IS WORK IN OTHER APARTMENT.

FINISHES NOTES:

- ALL NEW FLOORING TO BE LVT, KARDEAN VAN GOGH, COLOUR: WEATHERED ASH VGM43T, GLUE DOWN
- ALL NEW AND EXISTING WALLS TO HAVE NEW STANDARD GREY 4" VINYL WALL BASE. INSTALLED ON BOTH SIDES WHERE APPLICABLE
- ALL NEW CEILINGS TO BE GWB

NOTE 1

CONTRACTOR TO PROVIDE PTAC UNIT SHOP DRAWINGS FOR M/E CONSULTANT REVIEW AND APPROVAL, AND TO CONFIRM THAT IT CAN FIT WITHIN THE LOWER PART OF THE WINDOW.



Sheet Title:
NEW FLOOR PLAN - APARTMENT UNIT 2

Project:
KINGSTON & FRONTENAC HOUSING CORPORATION
COMMON ROOM CONVERSION
205 RIDEAU STREET, BASEMENT FLOOR, KINGSTON, ON

ARCHICANA

Date: 12/07/2024	Scale: 1:50
Drawn By: SS	Revision: PERMIT / TENDER
Sheet Number: A-310	

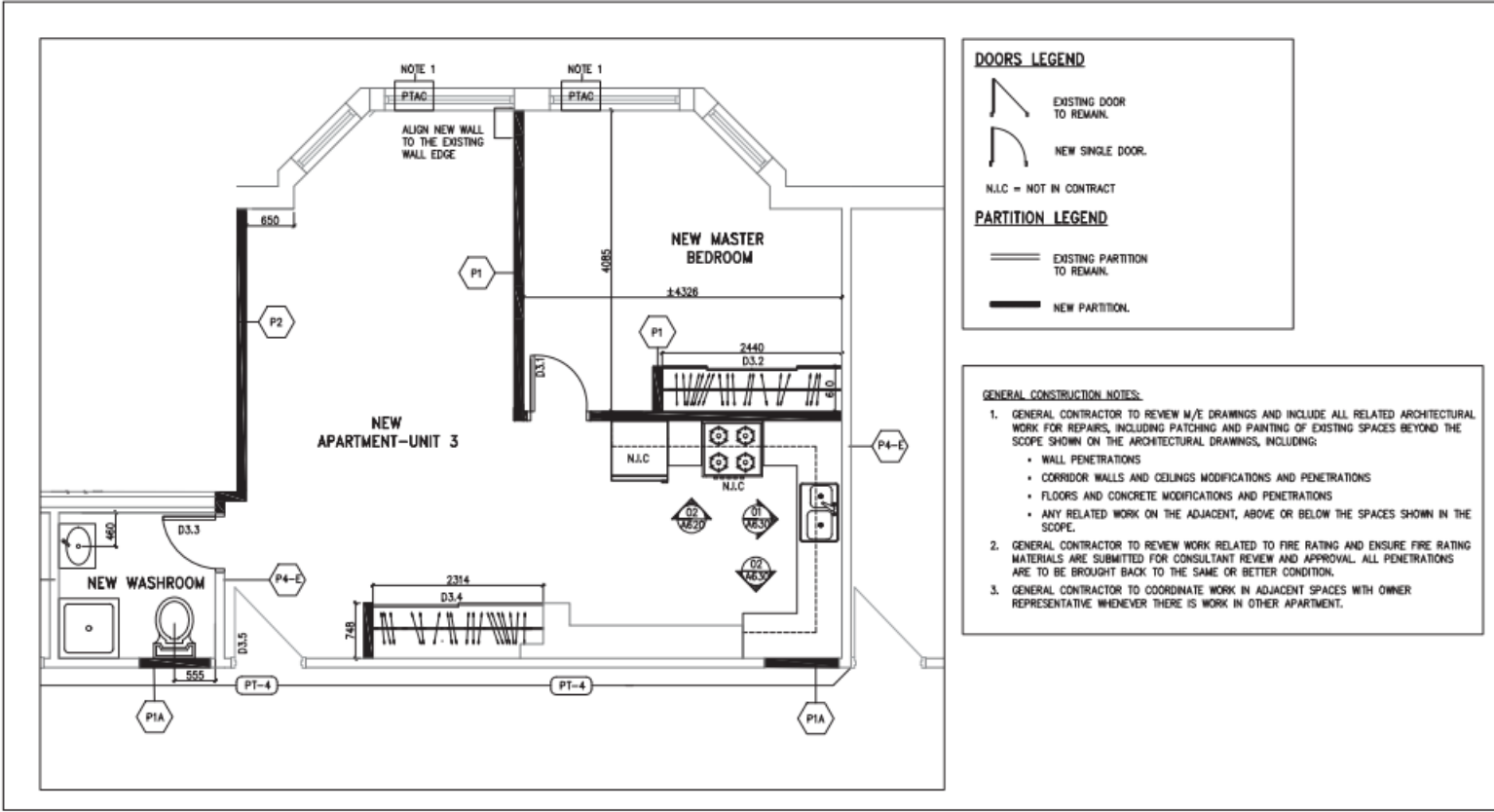

DOORS LEGEND

EXISTING DOOR TO REMAIN.

NEW SINGLE DOOR.

N.L.C = NOT IN CONTRACT

PARTITION LEGEND

EXISTING PARTITION TO REMAIN.

NEW PARTITION.

- GENERAL CONSTRUCTION NOTES:**
- GENERAL CONTRACTOR TO REVIEW M/E DRAWINGS AND INCLUDE ALL RELATED ARCHITECTURAL WORK FOR REPAIRS, INCLUDING PATCHING AND PAINTING OF EXISTING SPACES BEYOND THE SCOPE SHOWN ON THE ARCHITECTURAL DRAWINGS, INCLUDING:
 - WALL PENETRATIONS
 - CORRIDOR WALLS AND CEILINGS MODIFICATIONS AND PENETRATIONS
 - FLOORS AND CONCRETE MODIFICATIONS AND PENETRATIONS
 - ANY RELATED WORK ON THE ADJACENT, ABOVE OR BELOW THE SPACES SHOWN IN THE SCOPE.
 - GENERAL CONTRACTOR TO REVIEW WORK RELATED TO FIRE RATING AND ENSURE FIRE RATING MATERIALS ARE SUBMITTED FOR CONSULTANT REVIEW AND APPROVAL. ALL PENETRATIONS ARE TO BE BROUGHT BACK TO THE SAME OR BETTER CONDITION.
 - GENERAL CONTRACTOR TO COORDINATE WORK IN ADJACENT SPACES WITH OWNER REPRESENTATIVE WHENEVER THERE IS WORK IN OTHER APARTMENT.

FINISHES NOTES:

- ALL NEW FLOORING TO BE LVT, KARIDEAN VAN GOGH, COLOUR: WEATHERED ASH VGM43T, GLUE DOWN
- ALL NEW AND EXISTING WALLS TO HAVE NEW STANDARD GREY 4" VINYL WALL BASE, INSTALLED ON BOTH SIDES WHERE APPLICABLE
- ALL NEW CEILINGS TO BE GWB

NOTE 1

CONTRACTOR TO PROVIDE PTAC UNIT SHOP DRAWINGS FOR M/E CONSULTANT REVIEW AND APPROVAL, AND TO CONFIRM THAT IT CAN FIT WITHIN THE LOWER PART OF THE WINDOW.



Sheet Title:
NEW FLOOR PLAN - APARTMENT UNIT 3

Project:
KINGSTON & FRONTENAC HOUSING CORPORATION
COMMON ROOM CONVERSION
205 RIDEAU STREET, BASEMENT FLOOR, KINGSTON, ON

ARCHICANA

Date: 12/07/2024	Scale: 1:50
Drawn By: SS	Revision: PERMIT / TENDER
Sheet Number: A-320	